

STUD LOCATION DETAIL
WHEN UTILISING CB200 BRACKETS

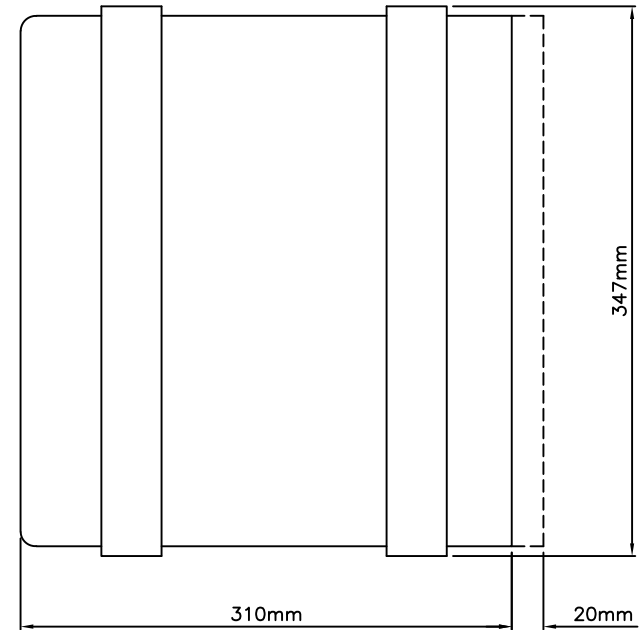
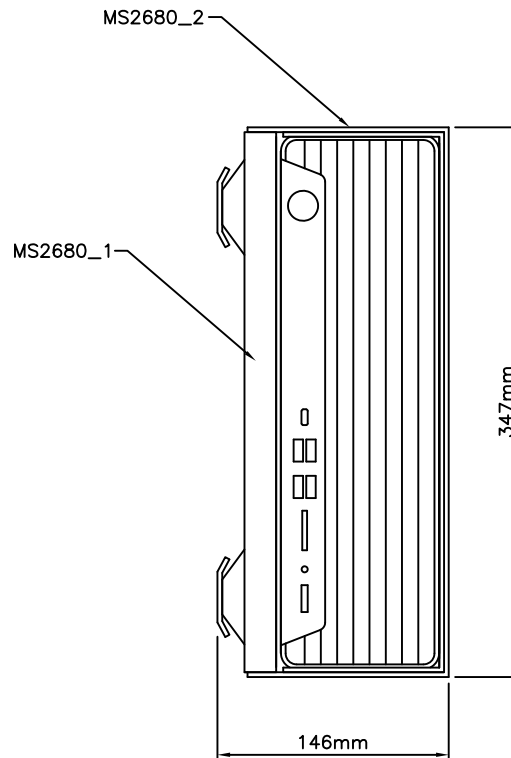

- NOTES:
- 1) SECURE KIT TO DOOR PANEL USING M5 NYLOC NUT AND WASHER (4 OFF)
 - 2) HOLE DETAILS:
'A': M5 x 14mm STUD (4 OFF)
 - 3) ALLOW 10mm CLEARANCE ON OVERALL DIMENSIONS FOR VIBRATION & VENTILATION
 - 4) ANTI-VIBRATION MOUNT DETAIL: BARRY CONTROLS M2K70-00280 (4 OFF)
 - 5) COMPATIBLE ACCESSORIES: CB200
 - 6) ENSURE RF 1004-MST-C IN-LINE FILTER IS FITTED TO THE AC POWER SUPPLY

MARINER
SYSTEMS
(UK) LTD

USED IN CONJUNCTION WITH:
HP Elite 800 G9 SFF PC
(VERTICAL MOUNT)

DRAWING TITLE: MS2680 ASSEMBLY

SCALE: DRAWN 1:1
ISSUE: 1

DWG NO: MS2680_CBA
DATE: 14 NOV 2022